

## LD Series

# Water Detector

**Not available for web orders. Call your sales rep for more information.**

Mount to floor, drip pan, or condensate pan

Solid state relay--no moving parts to fail

Gold-plated sensing electrodes for long-life



## DESCRIPTION

The LD series leak detector has the smallest footprint on the market, designed to detect water in even the tightest spaces. It is a fully encapsulated, potted design that is water-resistant (IPX7). Its gold-plated sensing probes are strategically positioned for optimal sensitivity to leaks. These are ideal for spot leak detection in various environments, including data centers, critical equipment areas, restrooms, and commercial kitchens.

## APPLICATIONS

- Ideal for spot leak detection
- Computer rooms, data centers, critical equipment, restrooms, or commercial kitchens
- Monitor condensate pans and drains—turn off equipment when pans reach limit
- Great for data centers

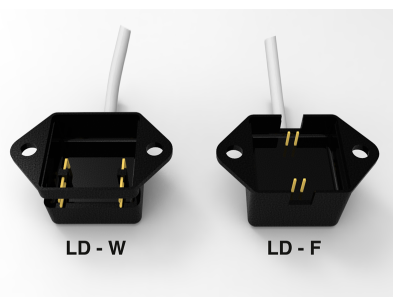

*Sensing Probes Are Close To Surface, For Fast Moisture Sensing*

*LD-F and LD-W is Buy American Act Compliant*

## FEATURES

- Reliable water detection
- Simple installation—screw, or ram-set to the floor or drip pan
- Simple operation—no maintenance
- Solid-state design... no moving parts to fail
- Fully encapsulated for water resistance... maximum durability

ORDERING

LD -



**Enclosure**

F = Floor Mounting

W = Wall Mounting

## DIMENSIONS

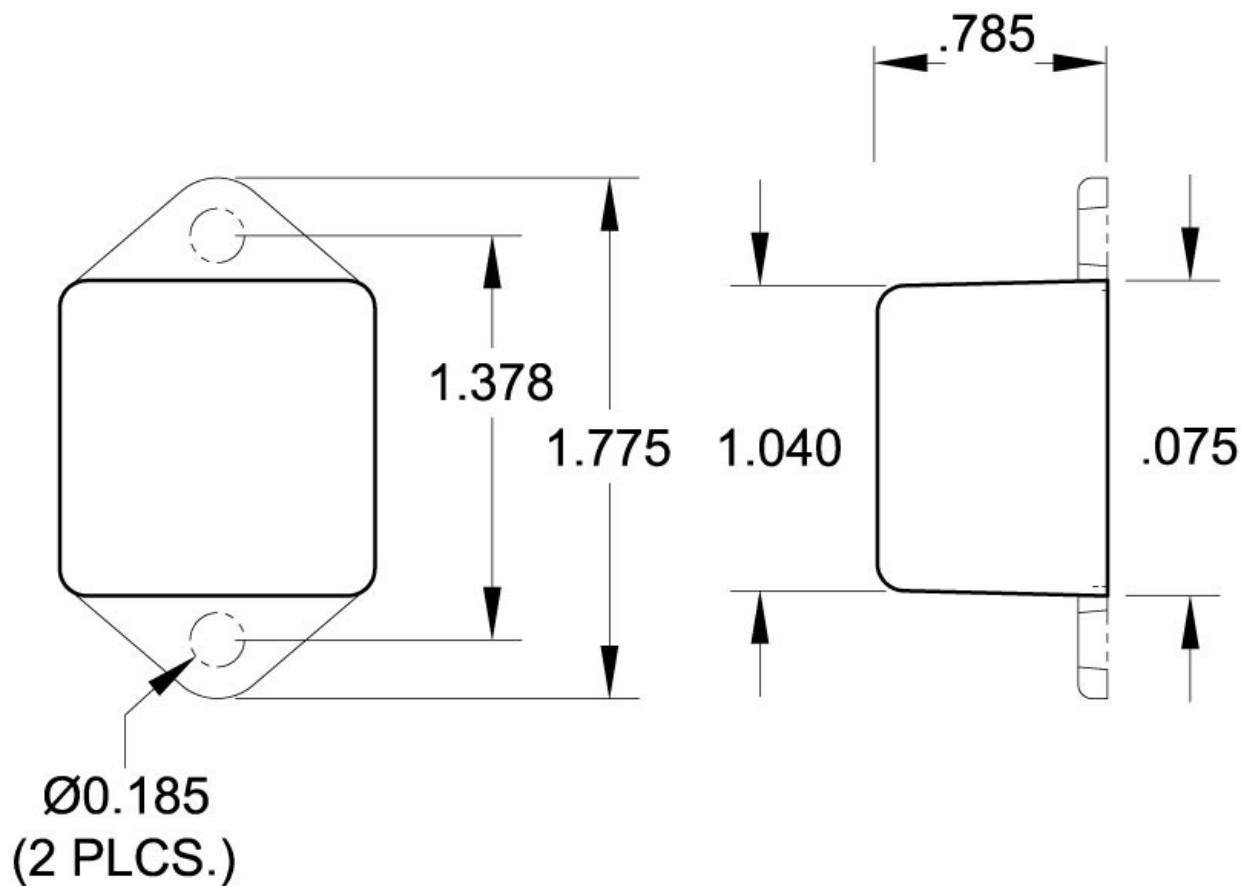

**Warning:** The datasheet is designed for reference only. Refer to installation instructions that accompany the product and heed all safety instructions. Product improvement is a continuing process at Senva. Changes may occur to products without prior notice.

## SPECIFICATIONS

Power Supply	9-30VAC/DC, 50mA Max. Isolated <sup>1</sup>
Output	N.O. Solid State Relay, Isolated N.C. when powered, opens when water detected
Output Rating	30VAC/DC, 0.1A (100mA) Max.
Cable Length	15 Ft. (4.572 m)
Sensing	Gold plated electrodes
Operating Environment	-20 to 50° C Air / 0-95% RH non-condensing 0 to 50° C submerged IPX7 rated

(1) Isolated power supply from earth ground required

*\* Product improvement is a continual process at Senva and product features and specification may change without prior notice. Refer to instructions that accompany the product for installation and wiring.*