

WD Series Water Detector

Solid state--no moving parts to fail
Gold plated sensing electrodes for long life
Floor and wall mount options



DESCRIPTION

The WD series detects water to prevent costly damage. Unlike float systems, it utilizes solid state detection, so is not prone to mechanical failure. The WD-1 is designed for mounting on the floor, drip pans or condensate pans, as the gold plated sensing electrodes face downwards out the back of the enclosure. The WD-2 housing accommodates mounting to a wall or vertical surface, with the gold plated sensing electrodes angled to the bottom of the enclosure.

APPLICATIONS

- Ideal for spot leak detection
- Computer rooms, critical equipment, restrooms or commercial kitchens
- Monitor condensate pans and drains—turn off equipment when pans reach limit



Detects water to prevent costly damage



WD-1 is designed for mounting on the floor, drip pans or condensate pans



Buy American Act Certified

FEATURES

- Reliable water detection
- Simple installation—screw, or ram-set to floor or drip pan
- Simple operation—no maintenance
- Solid-state design... no moving parts to fail
- Fully potted for water-proofing... maximum durability

ORDERING

DIMENSIONS

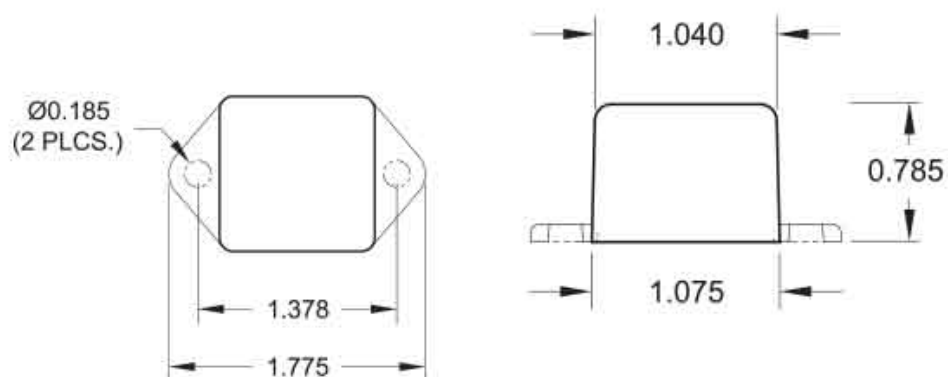

Warning: The datasheet is designed for reference only. Refer to installation instructions that accompany the product and heed all safety instructions. Product improvement is a continuing process at Senva. Changes may occur to products without prior notice.

SPECIFICATIONS

Power Supply	9-30VAC/DC, 20mA Max.
Output	N.C. (Form B) Solid State Relay, Isolated
Output Rating	30VAC/DC, 0.1A (100mA) Max.
Sensing	Gold plated electrodes
Operating Environment	-20 to 80oC

** Product improvement is a continual process at Senva and product features and specification may change without prior notice. Refer to instructions that accompany the product for installation and wiring.*